



中国国际进口博览会
CHINA INTERNATIONAL
IMPORT EXPO



CIIE NEW ERA
SHARED FUTURE
新时代 共享未来



SHANGHAI LET'S MEET

THE 7th CHINA INTERNATIONAL IMPORT EXPO

Media Guide



服务热线 | 86-21-968888
SERVICE HOTLINE



Online News Center

The Online News Center, with its website, WeChat account and applet, releases official information on the CIIE. It provides registered journalists with information on interview activities, important announcements, exhibits, media guide and services such as searching and downloading of texts, images and videos.



**China International
Import Expo Official
WeChat Account**

Registered journalists can log in to the Online News Center through the official website (www.ciiie.org) of the CIIE, or through the applet named “China International Import Expo” on WeChat APP. The QR code below is also available for the journalists to scan and acquire interview information after completing authentication.



中国国际进口博览会
CHINA INTERNATIONAL
IMPORT EXPO

CIIE NEW ERA
SHARED FUTURE
新时代 共享未来

Dear friends from the press,

The Seventh China International Import Expo (the “CIIE”) will be held at the National Exhibition and Convention Center (Shanghai) from November 5 to 10, 2024. Welcome to sign up for the coverage of the seventh CIIE.

The Media Center is located at A0 Office Building of NECC (No. 1088, Zhuguang Road, Qingpu District, Shanghai). It is the home open to domestic and foreign journalists covering the event from November 3 to November 10. We will do our best to offer services to facilitate your reporting activities during the CIIE. We will also keep updating useful and detailed information through the official website of the CIIE (www.ciie.org), the “Online News Center”, the Media Center Service Applet, and other channels. You are welcome to give us your feedback. Do feel free to let us know your suggestions.

Hope you will have a great time!

The CIIE Media Center
October 2024



Media Center
Service Applet



Promo video:
Shanghai, Another
Step Forward



Shanghai Basic
Facts 2024

China International Import Expo

The China International Import Expo (hereinafter referred to as the CIIE) is a major initiative personally planned, proposed, deployed, and advocated by President Xi Jinping. It represents a significant decision by China to advance high-level opening-up in the new era and serves as an important initiative for China to open its market to the world. Since its inaugural session in 2018, the CIIE has been consistently serving as a platform for four key functions: international procurement, investment promotion, cultural exchange, and open cooperation. It has become a gateway to building a new development pattern, a platform for promoting high-level opening-up, and an international public good shared by the world.



CIIE

Upholding the theme of “New Era, Shared Future”, the 7th CIIE will be held from November 5 to 10 in Shanghai, alongside the Hongqiao International Economic Forum (HQF). The exhibition will span over 420,000 square meters, featuring participation from 152 countries, regions, and international organizations in both country and enterprise exhibitions. The Hongqiao Forum will feature a main forum and 19 sub-forums. We warmly invite government officials, business leaders, exhibitors, and buyers from all countries to join us at 7th CIIE. This will be a unique opportunity to tap into the vast Chinese market, share development opportunities, and achieve mutually beneficial outcomes.





Notice

- For registered journalists, please go to a designated place to pick up media passes. The details on the pick-up time and location will be notified by email and on the official website of the CIIE.
- Media passes are for registered journalists only. Please do not lend them to others.
- The Media Center will provide services to assist registered journalists with interviews and reports at the CIIE.
- The Media Center will provide international radio and television signals, as well as official news images of major events during the CIIE.
- Registered journalists can learn about CIIE news, service information and announcements through the official website, the Online News Center, as well as the Service Applet, Information Desk, or the digital screens of the Media Center.
- The Media Center will arrange free media shuttle buses to take journalists between media-recommended hotels and Media Center at designated times. Registered journalists are requested to take the bus with media passes.



CONTENTS

- | | | | | | |
|----|--|--|----|--|--|
| 02 | | MEDIA PASS | 22 | | PRESS CONFERENCES |
| 03 | | INTRODUCTION TO
THE MEDIA CENTER | 23 | | INTERVIEW SERVICES |
| 14 | | LIVE BROADCAST POSITION &
SHARE LOUNGES | 24 | | CULTURAL EXHIBITIONS &
PERFORMANCES |
| 16 | | BOOKING & LEASING | 28 | | CATERING & REFRESHMENT |
| 21 | | OFFICIAL IMAGE SERVICES | 30 | | MEDIA-RECOMMENDED HOTELS |
| 21 | | RADIO COMMUNICATION
MANAGEMENT AND SERVICES | 34 | | TRANSPORTATION SERVICES |





Media Pass

As registered journalists, you can take the media shuttle buses and enter the Media Center, the media-recommended hotels and the CIIE venues with your media passes.

For those who will pick up the passes on site, please go to one of the designated places at designated time:

Pick-up Time:

8:00-22:00, November 3 to 4, 2024

Pick-up Location:

Registered journalists staying at the media-recommended hotels should go to the sub-media center of the hotels to collect the media passes.

Registered journalists who are not staying at the media-recommended hotels should go to the following place to collect the media passes:

Sub-media center of the CIIE (Lotus Hall, 1F, at Radisson Collection Yangtze Shanghai, No. 2099, Yan'an West Road, Changning District).

Contact: He FANG on 137 6409 8510 (hotel booking and media pass collection); Wanqi HUANG on 130 3113 9085 (media pass registration and collection)

Registered journalists who choose to extend your media passes of the sixth CIIE, or choose to collect the media passes by post, do not need to collect the media passes on site.



Introduction to the Media Center

The Media Center of the CIIE is located on the 1st to 3rd floors of Building A0 at the NECC (No. 1988 Zhuguang Road, near Gate 8 of the NECC).

Operation Time	
November 3	9:00-19:00
November 4	7:30-24:00
November 5	6:00-24:00
November 6-10	7:30-21:00
Contact Information	
Phone: (021) 9688888 Email: media@ciie.org	





Location Diagram of the Media Center

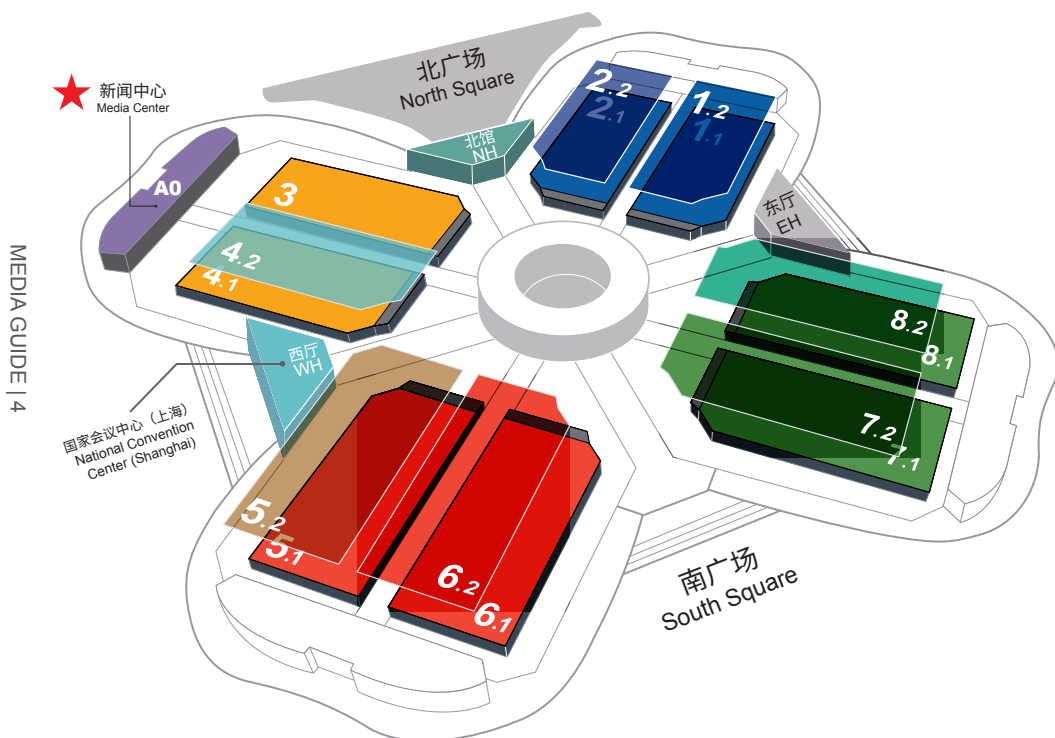

Note: The final layout is subject to the on-site arrangement.

In addition, please stay up-to-date via the official website of the CIIE (www.ciie.org).



Layout of Enterprise & Business Exhibition

WH
4.2

虹桥国际经济论坛
Hongqiao Forum

3
4.1

技术装备展区
Intelligent Industry & Information Technology

5.2

国家综合展
Country Exhibition

5.1
6.1
6.2

消费品展区
Consumer Goods

A0

新闻中心
Media Center

7.1
7.2
8.1

医疗器械及医药保健展区
Medical Equipment & Healthcare Products

1.1
1.2
2.2

食品及农产品展区
Food and Agricultural Products

8.2

服务贸易展区
Trade in Services

2.1

汽车展区
Automobile

NH

创新孵化专区
Innovation Incubation Special Section



Functional Areas of the Media Center

Functional areas including Information Desk, Media Workspace, Exclusive Media Workspace, Radio & Television Services Area, Press Conference Rooms, Interview Rooms and Catering and Refreshment Areas for Journalists are set up in the Media Center. Wi-Fi is also available within the Media Center.

Information Desk

The Information Desk on the 1st floor is to provide information services including major activities and news releases of the CIIE, press conference signing up, registration and application for media interviews inside or outside the venue. It also offers services such as transportation and accommodation, introduction to Shanghai and nearby tourist attractions, as well as handout distribution and lost & found, etc.

The Booking Office on the 2nd floor is to provide registered media with services including exclusive media workspace, office facilities and equipment renting, interview room renting, radio and television services, and satellite transmission services.

Official Image Center allows you to free search and download official images.

Media Workspace

Media Workspace is on the 2nd floor. Multiple cubicles for journalists are provided, each of which is equipped with three interfaces for digital audio, network and power supply respectively, and some of which are provided with desktop computers.

Large LED screens and televisions will provide public signal pictures in real time and provide information about the CIIE.

A printing area has been set up, equipped with fax machines, telephones, printers, copiers and other office equipment, as well as electronic storage cells.

A live broadcast position has been set up in the media workspace for live streaming.

Exclusive Media Workspace

The Media Center has exclusive media workspace for leasing, each of which is equipped with power supply, broadband network coverage, HB signals and a cable TV interface. Telephones, fax machines, printers, computers and office furniture are also available.



Radio & Television Services Area

The Master Control Room (MCR) is on the 2nd floor of the Media Center.

Services such as receiving and recording of public radio and television signal, satellite transmission, and new media streaming are also available in the Media Center.

Press Conference Rooms

Three conference rooms in small, middle and large size are on the 3rd floor. A series of press conferences will be held during the CIIE.

Interview Room

The Media Center has interview rooms on the 2nd floor which is available for booking.

Catering and Refreshment Area

The media refreshment area is on the 2nd floor, serving free coffee, tea and snacks.

The media catering area is also on the 2nd floor, providing journalists with lunch and dinner.

Clinic

The clinic is on the 2nd floor, providing emergency medical services.





新闻中心 MEDIA CENTER 导览图 GUIDE MAP

A Information Area

A-1: Information Desk



Elevator

B Exclusive Media Workspace

J Press Conference Rooms

J-1: Press Conference Room A

J-2: Press Conference Room B

J-3: Press Conference Room C



Women's Washroom



Men's Washroom



Elevator

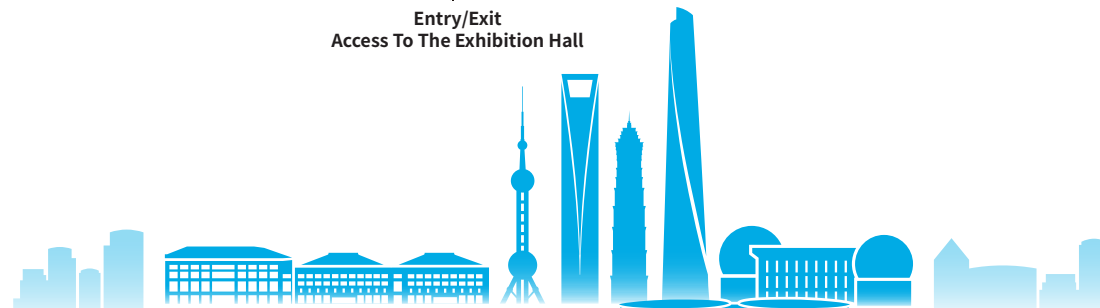
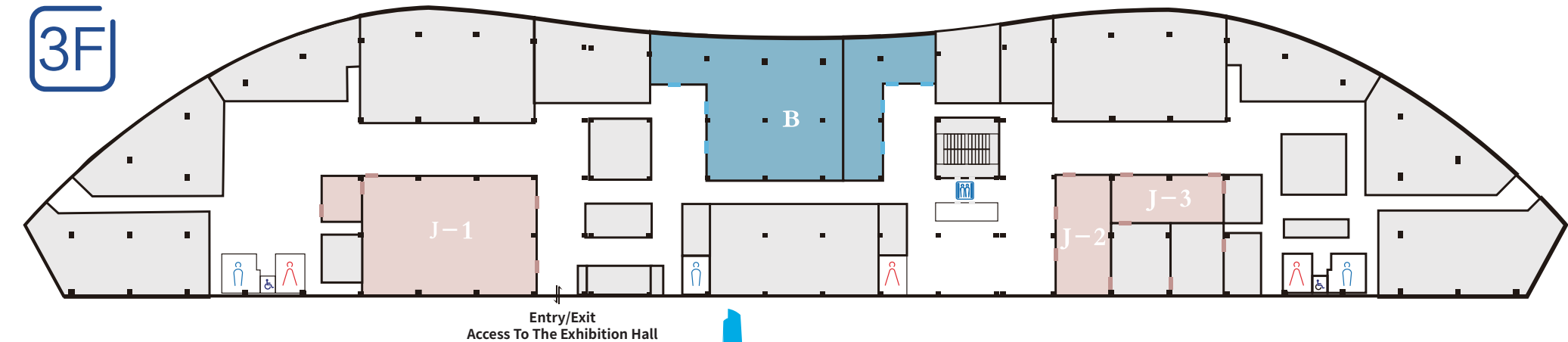
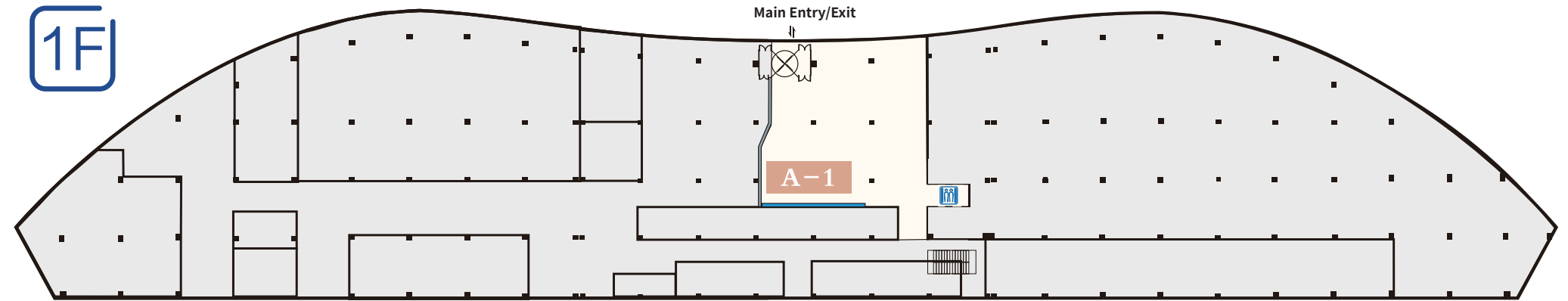

2F

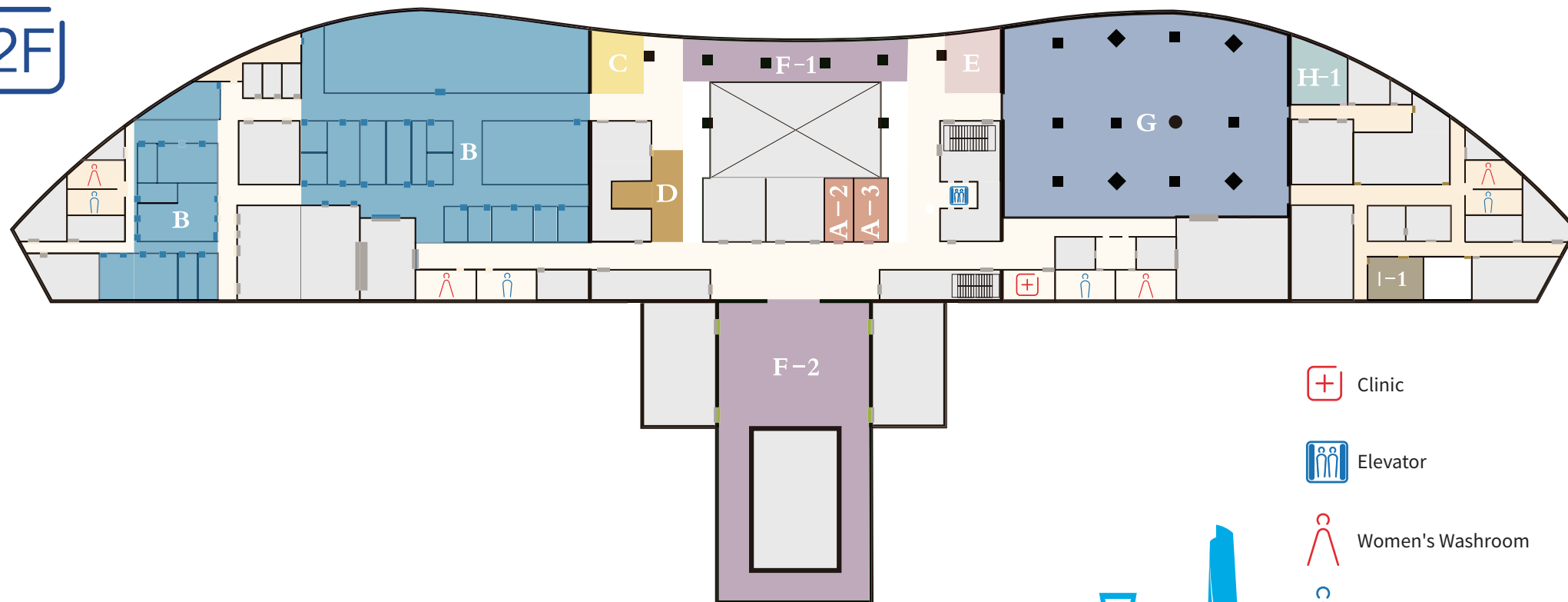

新闻中心 MEDIA CENTER 导览图 GUIDE MAP

A Information Area

A-2: Official Image Center
A-3: Booking Office

B Exclusive Media Workspace

C Meet ICH (Intangible Culture Heritage) of Shanghai

D SH Study

E ArtStage

F Catering & Refreshment Area

F-1: Media Refreshment Area
F-2: Media Restaurant

G Media Workspace

H Interview Room

H-1: Interview Room

I Radio & Television Services Area

I-1: HB Signal Room



Clinic



Elevator



Women's Washroom



Men's Washroom



中国国际进口博览会
CHINA INTERNATIONAL IMPORT EXPO

CIIE NEW ERA
SHARED FUTURE
新时代 共享未来



SHANGHAI LET'S MEET



Live Broadcast Position and Share Lounges

| Live Broadcast Position

The live broadcast position is in the middle of Media Working Area to facilitate live news coverage.

5G is available within the NECC. Journalists can apply for 5G signal transmission services through the “Online News Center” or the Booking Office of the Media Center.





I Share Lounges

Share lounges have been distributed around the exhibition halls, equipped with drinking water, power charging equipment, internet coverage and other office facilities. Registered journalists may take a rest or work there.

Location of Media Lounges

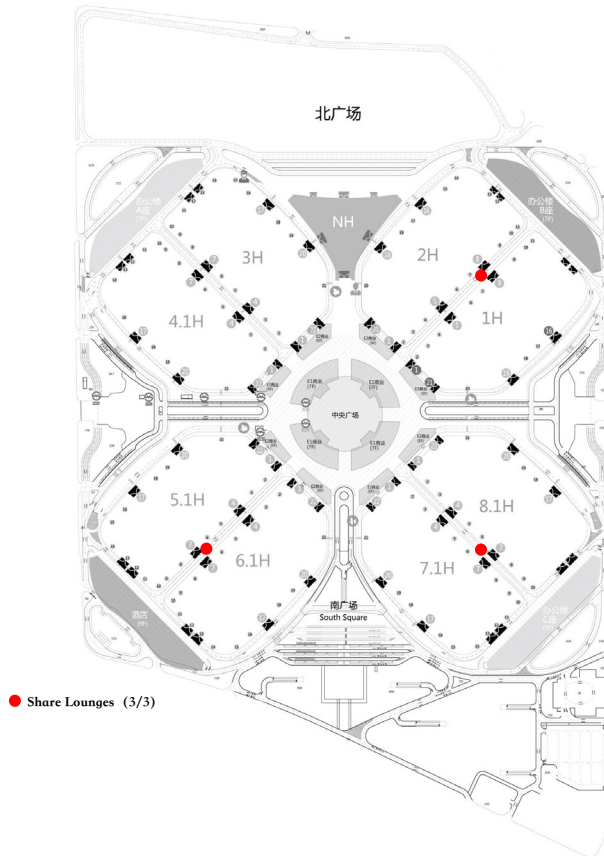



Booking and Leasing

The Booking Office provides the registered media with booking services for exclusive media workspace, interview room, live broadcast position, office facilities and equipment, radio and television technology, satellite transmission, etc.

All booking and rental services will be arranged according to the principle of “first come, first served”.

Phone: (021) 39888061; (021) 39888062

Email: ibcbooking@ciie.org

Basic Facilities of Interview Room:

Area: 70 m²

Technical power, office power and UPS power will be distributed on demand

1 set of professional lightings

1 telephone interface

1 high-speed network interface

1 satellite transmission port

1 standard background board

4 long tables

4 chairs

2 armchairs

1 tea table



I Sketch Map of Interview Room

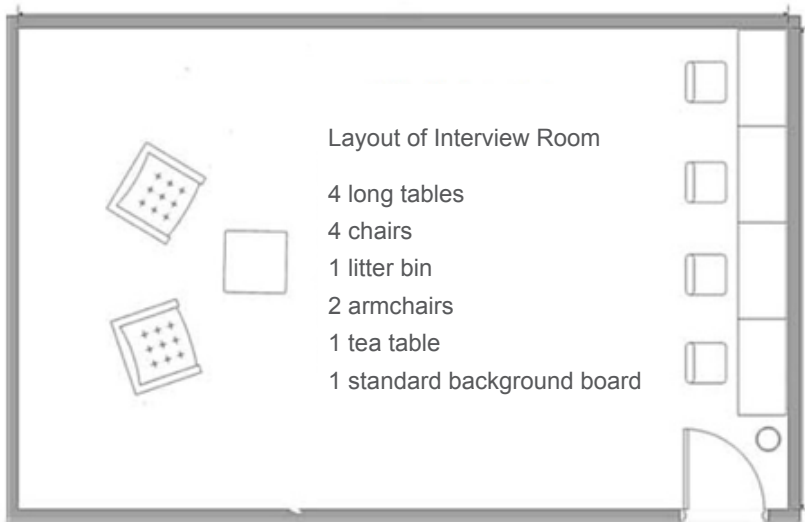

If you need any additional services, such as telecommunications, more office facilities and equipment, cable TV interfaces, video interfaces, or satellite uploading ports, please make applications at the Booking Office.



Booking and Leasing

I Radio and TV services

The radio and TV services provided by the Media Center are as follows:

S/N	Items	Services
1	Public signals collection	Real-time public signals receiving and recording
2	Video and audio transmission channels between workshop and MCR	Real-time satellite transmission
3	Public signal Channel 1 between MCR and working places	
4	Single-point satellite transmission	Equipment rental services with technicians (self-owned equipment is allowed)



S/N	Items	Services
5	Radiographic satellite transmission	Radiographic equipment rental services (self-owned equipment is allowed)
6	Satellite channels	Satellite transmission to Asia, Europe, America and other parts of the world
7	5G signal transmission	5G wireless transmission is provided
8	Real-time streaming of public signals through network	Format conversion and real-time streaming service of various media formats, including file transferring.

HB Signals

Signal format: High Definition Digital (Embedded Audio)

Signal: 1080i/50(16:9)

Interface standard: BNC (Q9)

Format standard: PAL



Application Procedure

1. Online Booking

Registered journalists may telephone or email the Booking Office of the Media Center about the specific booking and leasing services and their charges, or log in to the media registration system to get the relevant information and download the application form.

After the application forms are completed, please email them to the Booking Office: ibcbooking@ciie.org. The Booking Office will confirm booking services and fees within three days after receiving the application form.

2. On-site Booking

During the operation of the Media Center, on-site applications made by registered media will be accepted at the Booking Office.

Settlement Currency and Payment

The prices of booking and leasing services will be quoted in RMB. If a payment is made in US dollars, it will be calculated at the exchange rate issued by the People's Bank of China on the same day.

The Booking Office accepts cash payments, credit card payments and bank transfers.



Official Image Services

The Media Center provides registered journalists with free on-site downloading service for official images. Please apply for relevant services at the Official Image Center.

Radio Communication Management and Services

During the CIIE, organizations or individuals (including registered journalists) that need to use radio transmission equipment (wireless cameras, walkie-talkies, wireless microphones and so on) in the Media Center and exhibition areas must apply to Shanghai Municipal Commission of Economy and Informatization (Shanghai Radio Administration) in advance and go through the relevant formalities.

Registered journalists should enter the Online News Center to download and fill out the Radio Frequency Declaration Form of the China International Import Expo and submit it to the mailbox (luwq@sheitc.sh.gov.cn) for application.



Press Conferences

During the CIIE, a number of press conferences on the outcomes, products, agreements and events will be held in three conference halls of the Media Center.

Registered journalists can find detailed information about the press conferences and sign up through the Online News Center of the CIIE, and the Information Desk on the 1st floor of the Media Center.





Interview Services

During the CIIE, the Media Center will launch a series of interview activities of "Face-to-Face with Overseas CEOs", inviting Chinese and foreign journalists to interview the senior executives of CIIE participating companies. There are themed press tours covering the National Exhibitions, Enterprise Exhibitions and other major exhibition areas of the CIIE. Some CIIE exhibitors are also invited to the Media Center to provide more opportunities for journalists to interview and communicate with exhibitors "at close range".

The Media Center will also arrange off-site reporting routes focusing on the latest economic and social development of Shanghai both in Chinese and foreign languages.

Registered journalists of the CIIE can make appointments for all the interviews above through the "Online News Center" or at the Information Desk on the 1st floor of the Media Center.





Cultural Exhibitions and Performances

Publication Display & Impressions of Shanghai

Publication Display and Impressions of Shanghai Short Video Screening Area is on the 2nd floor, offering complimentary copies of books and audio-visual products reflecting Xi Jinping's Thought on Socialism with Chinese Characteristics for the New Era, Shanghai to build the best practice area of Xi Jinping Thought on Culture, and the achievements of Shanghai's high-quality cultural, economic, social development as well as Shanghai's international images, showing the characteristics of the intergration of “culture, sport, business, tourism and exhibition”, so that Chinese and foreign journalists can feel the vigorous charm of Shanghai.





Meet ICH (Intangible Culture Heritage) of Shanghai

This space creates an immersive experience of a living room of intangible culture heritage of Shanghai in a scenario-based and life-based manner. Through the exhibition of Shanghai's traditional fine arts and crafts with profound cultural accumulation and unique aesthetic style, as well as colorful and interesting interaction with the intangible culture heritage, it shows the charm of the ICH of Shanghai as well as the outstanding Chinese traditional culture to Chinese and foreign journalists.





Cultural Exhibitions and Performances

SH Study

The study is composed of “Reading Space”, “Leisure Space” and “Cultural and Creative Space”, dedicated to creating a “living room” of the Media Center. Through thousands of books and magazines in multiple languages and a number of interactive activities, this area will immerse journalists from home and abroad in the cultural elegance and the urban atmosphere of Shanghai surrounded by the fragrance of books.





ArtStage

The theme of the “ArtStage” is to gather music of the whole world and create future music together. It will invite outstanding artists and groups at home and abroad to give wonderful performances and offer immersive experience for Chinese and foreign journalists. Excellent performances of the Shanghai International Art Festival have been introduced to the Media Center of the CIIE for the first time, present the elegance of Chinese music culture and show the unique characters and style of the city of Shanghai.





Catering and Refreshment

Media Catering Area

Located on the 2nd floor of the Media Center (Area F-2).

Type: Free buffet

Service Time:

November 3 Dinner 17:30-19:00

November 4-10 Lunch 11:30-14:00 Dinner 17:30-19:30

We suggest you avoid the peak hours for better dining experience.





Media Refreshment Area

Located in the middle area of the 2nd floor (Area F-1).

Service time:

November 3 9:00-19:00

November 4 7:30-20:00

November 5 6:00-20:00

November 6-10 7:30-20:00





Media-Recommended Hotels

We have chosen 8 media-recommended hotels (at your own expense) for registered journalists and have arranged free shuttle buses between those hotels and the Media Center. Each recommended hotel has a sub-media center, providing network services, computers, printers, copiers and other office equipment, as well as interview information, tea break, medical services, taxi booking and assistance in booking air tickets, train tickets and other services.

Registered journalists are advised to make reservations at recommended hotels as soon as possible (Reservation System: <http://ciie.oddb.sh.cn/>).

Media-recommended Hotels

Radisson Collection Yangtze Shanghai

Address: 2099 Yan'an West Road, Changning District
Tel: 021-62750000

-  To rail transit: Metro Line 10 (Yili Road Station) around 0.7 KM, Line 3/4 (Yan'an West Road Station) around 1.3 KM
-  To the NECC: around 14 KM
-  To Shanghai Pudong International Airport: around 50 KM
-  To Shanghai Hongqiao International Airport/ Hongqiao Train Station: around 11 KM

Booking website: <http://ciie.oddb.sh.cn>



The Kunlun Jing An

Address: 250 Huashan Road, Jing'an District
Tel: 021-61710000



To rail transit: Metro Line 2/7/14 (Jing'an Temple Station) around 0.4 KM



To the NECC: around 18 KM



To Shanghai Pudong International Airport: around 45 KM



To Shanghai Hongqiao International Airport/ Hongqiao Train Station: around 15 KM

Booking website: <http://ciie.odt.sh.cn>

Jianguo Hotel

Address: No. 439 North Caoxi Road, Xuhui District
Tel: 021-64399299



To rail transit: Metro Line 1 (Xujiahui Station) around 0.5 KM, Metro Line 9/11 (Xujiahui Station) around 0.6 KM



To the NECC: around 20 KM



To Shanghai Pudong International Airport: around 48 KM



To Shanghai Hongqiao International Airport/ Hongqiao Train Station: around 14 KM

Booking website: <http://ciie.odt.sh.cn>



Media-recommended Hotels

Jin Jiang Metropolo Hua Ting Guest House

Address: 2525 Zhongshan West Road, Xuhui District
Tel: 021-64391818

-  To rail transit: Metro Line 1/4 (Shanghai Gymnasium Station) around 0.3 KM, Line 3 (Caoxi Road Station) around 0.6 KM
-  To the NECC: around 18 KM
-  To Shanghai Pudong International Airport: around 46 KM
-  To Shanghai Hongqiao International Airport/ Hongqiao Train Station: around 15 KM

Booking website: <http://ciie.odt.sh.cn>

Vienna International Hotel (Jinshajiang Road)

Address: 299 Nujiang Road, Putuo District
Tel: 021-62578888

-  To rail transit: Metro Line 13 (Daduhe Road Station) around 0.4 KM
-  To the NECC: around 17 KM
-  To Shanghai Pudong International Airport: around 54 KM
-  To Shanghai Hongqiao International Airport/ Hongqiao Train Station: around 15 KM

Booking website: <http://ciie.odt.sh.cn>



Jinjiang Inn (NECC)

Address: 888 Jidi Road, Minhang District

Tel: 021-60980989



To rail transit: Metro Line 17 (NECC Station) around 3 KM



To the NECC: around 4 KM



To Shanghai Pudong International Airport: around 65 KM



To Shanghai Hongqiao International Airport/ Hongqiao Train Station:
around 8 KM

Booking website: <http://ciie.odt.sh.cn>

Campanile Shanghai (Jing'an)

Address: 425 Urumqi North Road, Jing'an District

Tel: 021-61076288



To rail transit: Metro Line 2 (Jing'an Temple Station) around 0.7 KM,
Metro Line 7 (Jing'an Temple Station) around 0.9 KM, Metro Line 14
(Jing'an Temple Station) around 0.5 KM



To the NECC: around 15 KM



To Shanghai Pudong International Airport: around 35 KM



To Shanghai Hongqiao International Airport/ Hongqiao Train Station:
around 13 KM

Booking website: <http://ciie.odt.sh.cn>

San Want Hotel Shanghai

Address: 650 Yishan Road, Xuhui District

Tel: 021-61451111



To rail transit: Metro Line 9 (Guilin Road Station) around 0.2 KM



To the NECC: around 21 KM



To Shanghai Pudong International Airport: around 35 KM



To Shanghai Hongqiao International Airport/ Hongqiao Train Station:
around 13 KM

Booking website: <http://ciie.odt.sh.cn>



Transportation Services

Online News Center, the Media Center Service Applet, the Information Desk on 1F of the Media Center, and sub-media centers in the media-recommended hotels will provide you with transportation service information such as pick-ups and drop-offs, media shuttle bus routes and timetables, etc.

I. Arrivals and departures

1. Group pick-up service

On November 3-4, when more than 20 accredited journalists arrive in Shanghai on the same flight or train, a customized shuttle will be arranged according to the appointment. You may also choose airport shuttles, rail transit, taxis or other public transport means to go to the media-recommended hotels.

2. Group drop-off service

On November 11, when more than 20 registered journalists leave Shanghai on the same flight or train, a customized shuttles will be arranged according to the appointment.



II. Media Shuttle Service

During the seventh CIIE, the Media Center will provide free media shuttle services for registered journalists between the recommended hotels and the Media Center.

Date	Route	Media Hotel →Media Center	Media Center →Media Hotel	Media Center→ Media Hotel / People’s Square	
	Time				
November 4	07:00	09:00	16:00	20:00-21:00 (Every 15 minutes) 21:00-22:00 (Every 30 minutes) After 22:00 (Reservation only)	
	09:00				
	14:00				
November 5	06:30-7:00 (Every 30 minutes)				
November 6-10	07:00-10:00 (Every 30 minutes)	14:00-15:00 (Every 30 minutes)	15:00-16:00 (Every 30 minutes)		

The timetable may be adjusted according to the CIIE schedule. Any adjustment will be informed in time. Please pay attention to the announcements on the Online News Center and the Media Center Service Applet, and at the Information Desk on 1F of the Media Center and the sub-media centers in the media-recommended hotels.



III. Navigation to NECC (Shanghai)

The National Exhibition and Convention Center (Shanghai) is located in the core area of the Hongqiao Business District in Shanghai, only 1.5 kilometers from the Hongqiao Transportation Hub, and is directly connected to the Hongqiao High-speed Railway Station and Hongqiao Airport by metro. The surrounding expressway network extends in all directions, and major cities in the Yangtze River Delta can be reached within 2 hours, making transportation very convenient.



1) Rail Transit

You can take Metro Line 2 to National Exhibition and Convention Center Station or Line 17 to National Exhibition and Convention Center Station to reach the National Exhibition and Convention Center (Shanghai). Line 2 connects with Lines 1, 3, 4, 6, 7, 8, 9, 10, 11, 12, 13, 14, 15, 16 and 18, making it easy to reach all parts of Shanghai; Line 17 can connect with Lines 2 and 10 at Hongqiao Railway Station.



2) Airport

The National Exhibition and Convention Center (Shanghai) is approximately 4.5 kilometers (straight-line distance) from Hongqiao Airport Terminal 1, approximately 2 kilometers (straightline distance) from Hongqiao Airport Terminal 2, and approximately 60 kilometers from Pudong International Airport. You can take metro to the National Exhibition and Convention Center (Shanghai) from all those terminals.

I. **Hongqiao Airport Terminal 1-National Exhibition and Convention Center (Shanghai)**

Metro: Take Metro Line 10 to Hongqiao Railway Station and transfer to Metro Line 2 to National Exhibition and Convention Center Station

Taxi: About 20 minutes (10 km)

II. **Hongqiao Airport Terminal 2-National Exhibition and Convention Center (Shanghai)**

Metro: Take Metro Line 2 to National Exhibition and Convention Center Station

Taxi: About 10 minutes (6 km)

III. **Pudong International Airport-National Exhibition and Convention Center (Shanghai)**

Metro: Take Metro Line 2 to National Exhibition and Convention Center Station

Taxi: About 70 minutes (about 60 km)



3) Train Station

I. **Shanghai Hongqiao Railway Station - National Exhibition and Convention Center (Shanghai)**

Metro: Take Metro Line 2 to National Exhibition and Convention Center Station, or Metro Line 17 to National Exhibition and Convention Center Station

Taxi: About 10 minutes (6 km)

II. **Shanghai Railway Station - National Exhibition and Convention Center (Shanghai)**

Metro: Take Metro Line 3 or 4 to Zhongshan Park Station and transfer to Metro Line 2 to National Exhibition and Convention Center Station

Taxi: About 35 minutes (25 km)



III. Shanghai South Railway Station - National Exhibition and Convention Center (Shanghai)

Metro: Take Metro Line 3 to Zhongshan Park Station and transfer to Line 2 to National Exhibition and Convention Center Station

Taxi: About 30 minutes (23 km)



4) Self-driving

I. Yangtze River Delta Region

People from Hangzhou, Ningbo and Suzhou can drive via G60 and G2 expressways to G15 Shenyang-Haikou Expressway - Songze Elevated Road - Zhuguang Road Off-Ramp - Songze Avenue - National Exhibition and Convention Center (Shanghai); or via Huaxu Highway - Songze Avenue - National Exhibition and Convention Center (Shanghai).

II. Shanghai Downtown Elevated Roads

- Yan'an Elevated Road, Southern Outer Ring Expressway Direction: Jiamin Elevated Road - Jianhong Elevated Road - Yinggang East Road - Zhuguang Road - Songze Avenue - National Exhibition and Convention Center (Shanghai)
- Beizhai Elevated Road, North Outer Ring Expressway Direction: Beizhai Elevated Road - Lianyou Road Exit - Zhuguang Road Underground Tunnel - Songze Avenue - National Exhibition and Convention Center (Shanghai)

III. Ground Roads

- Beizhai Road, West Tianshan Road, West Xianxia Road direction: Shenchang Road or Huaxiang Road - Songze Avenue - National Exhibition and Convention Center (Shanghai)
- Yan'an Road Direction: West Yan'an Road - Huqingping Highway - Zhuguang Road - Songze Avenue - National Exhibition and Convention Center (Shanghai)

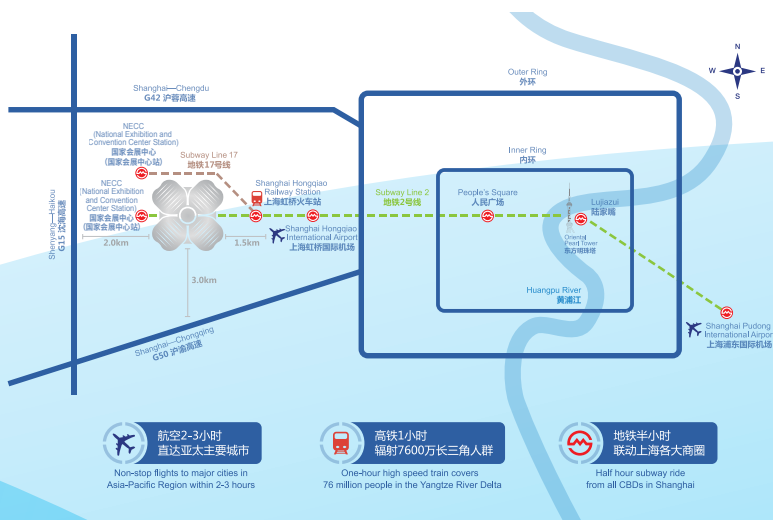



中国国际进口博览会
CHINA INTERNATIONAL
IMPORT EXPO

CIIE NEW ERA
SHARED FUTURE
新时代 共享未来



SHANGHAI LET'S MEET



扫码进入 进博会官微
SCAN THE QR CODE TO VIEW
CIIE WECHAT ACCOUNT